

INCREMENTAL ENCODER

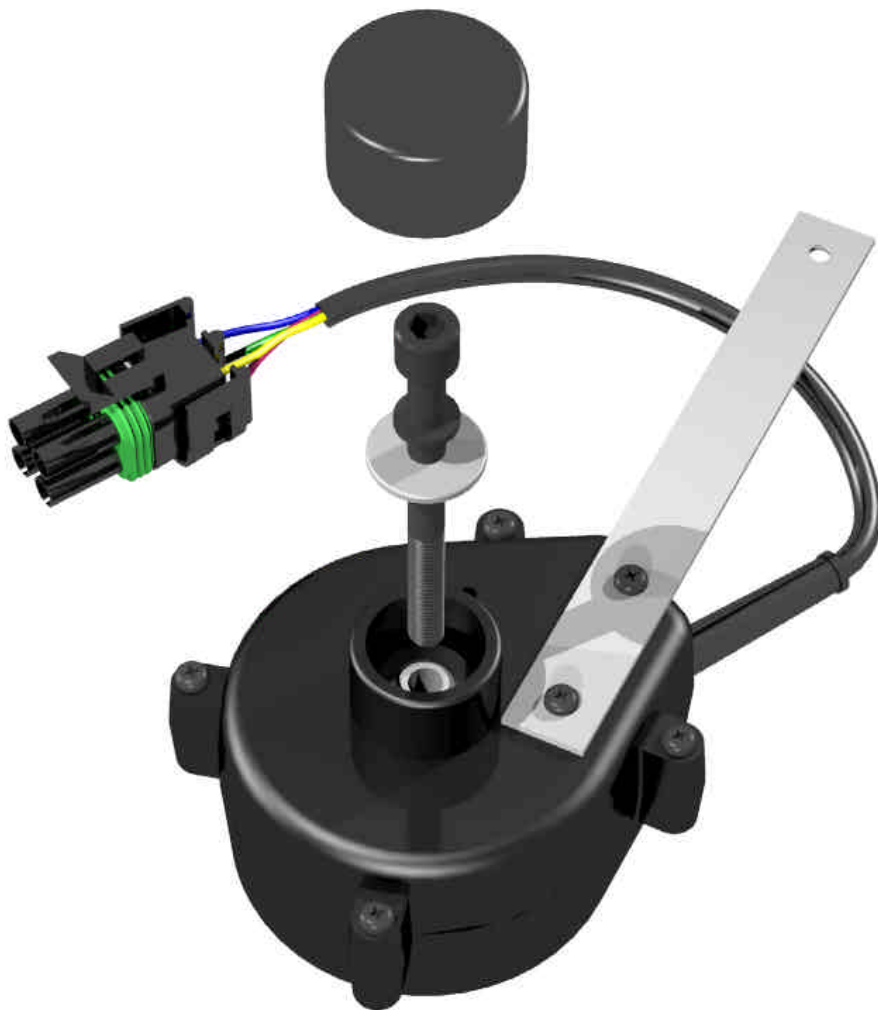

DESCRIPTION:

The RDS incremental shaft encoder is a non-contacting rotary to digital converter used to provide accurate shaft speed information. It has been designed for a wide range of OEM applications where simplicity, ease of installation and reliability is of prime consideration. The unit provides 2 square wave output signals that enable the direction of rotation to be determined (quadrature). A diagnostic LED ensures the functionality of the device is easy to determine.



INCREMENTAL ENCODER - Specification

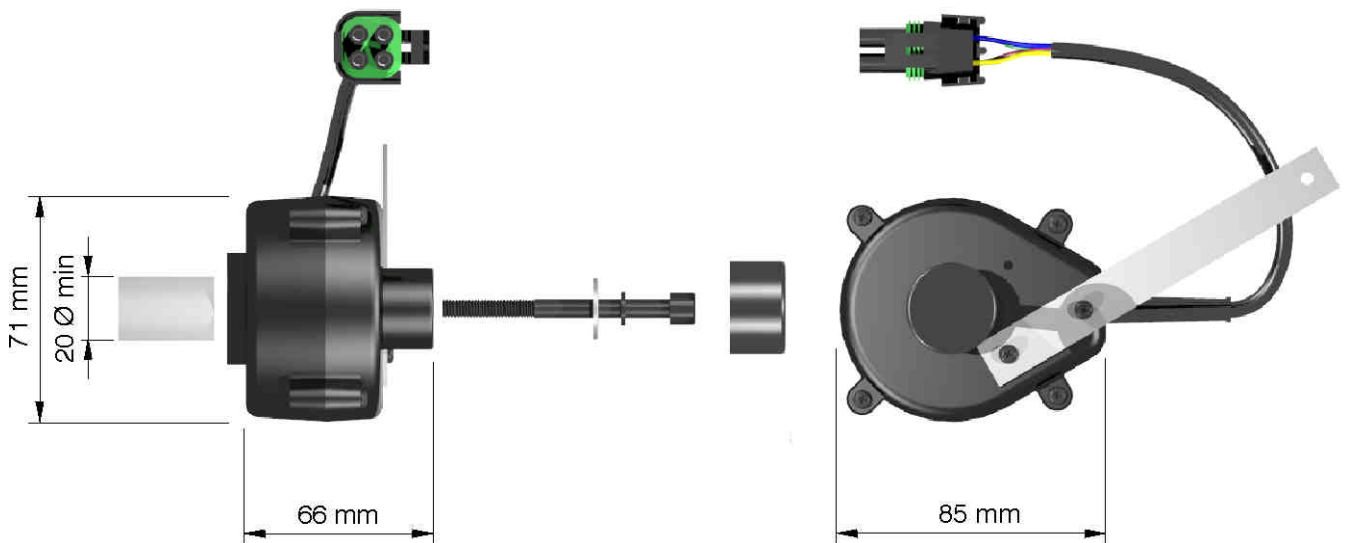

Mechanical:

Enclosure Material: Grivory GV-5H

Shaft Material: Stainless Steel

Securing Method: M6 Caphead Screw

Disc Material: BS1449 Full Hard CS4 Steel chemically blackened

Maximum RPM: 7500 RPM (based on 360 PPR)

Bearing Life: 70 x 109 revolutions (minimum) at full shaft speed

Minimum mounting diameter for shaft: 20 mm

Electrical:

Code: Incremental

Resolution: 180, 360 PPR (others available upon request, contact RDS for further details)

Power Supply: 8 - 30 Volts

Format: Two channel quadrature, square wave

Output: Open Collector; 30 VDC max., 40mA sink max.

Phase Sense: A leads B for CW rotation (viewed from securing bolt side of encoder)

Cable Termination: 300mm flying lead to '4way' Weatherpack as standard (others to order)

Protection: Reverse polarity, over voltage and output short circuit

Environmental:

Sealing: IP66

Temperature: -10°C to 70°C operating, -25°C to 90°C storage

Shock: 50 G's for 11 milliseconds duration

Vibration: 5 - 200 Hz @ 20 G's

Humidity: 98% RH without condensation



RDS TECHNOLOGY LTD. CIRENCESTER RD, MINCHINHAMPTON, STROUD, GLOS. GL6 9BH UK

TEL:+44 (0)1453 733300 FAX:+44 (0)1453 733311

E-MAIL: rds.sales@rdstec.com WEB: www.rdstec.com